

# DCU CONTROL SYSTEM

UNIVERSAL  
OPEN  
LOW-COST  
ADVANCED



HOBBY  
RESEARCH  
EMBEDDED  
INDUSTRY  
HVAC/BUILDING

FROM

## EMBEDDED REAL-TIME CONTROL



THROUGH

## CONTROL OF EXPERIMENTAL AND HOBBY TECHNOLOGIES

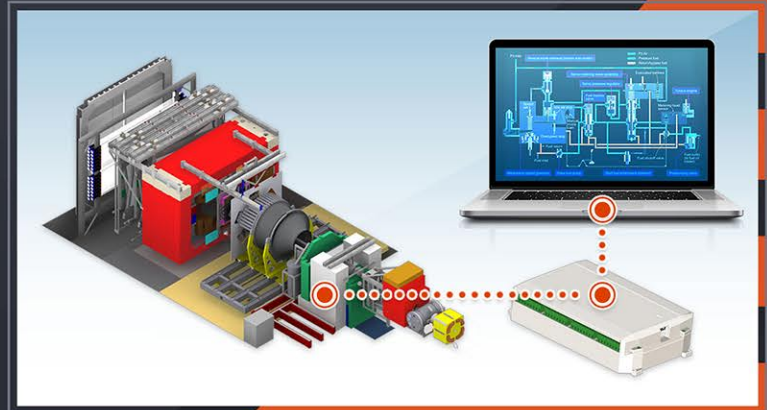

DOWN TO

## COMPLEX PROCESS CONTROL



### ADVANTAGES

Highly scalable - performance/price flexibility

Optimal cost/performance ratio

All software free

Low investment costs

Supports Win/Linux/Mac/Android

Low installation costs + optimal performance

Open-source software platforms

Customer is not dependent on manufacturer

Free user support

Implementation simplicity

Most advanced design/optimization techniques

Optimal and reliable control of technology

# CONTROL SYSTEM STRUCTURE

## VISUALIZATION / SCADA

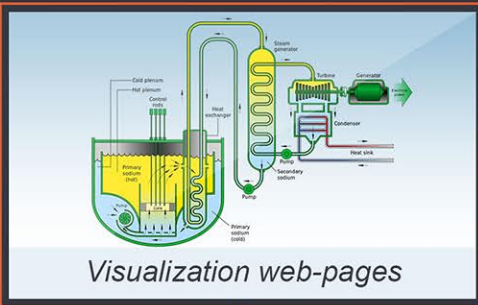

## DESIGN AND PROGRAMMING

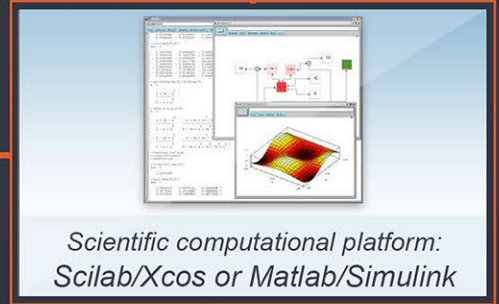
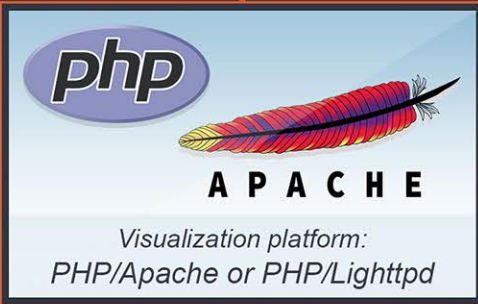

## APPLICATION INTERFACE



## OPERATING SYSTEM

PC / miniPC / industrial PC / notebook / server / microserver / tablet



## NETWORKING

Wireless access point  
LAN / WAN network  
UTP/FTP cable  
Switch  
Router

Ethernet technology  
Wireless technology  
UDP/TCP/IP  
Internet

## REAL-TIME CONTROL

Dynamic Control Units (DCU) / Intelligent Modbus devices / Modbus I/O modules

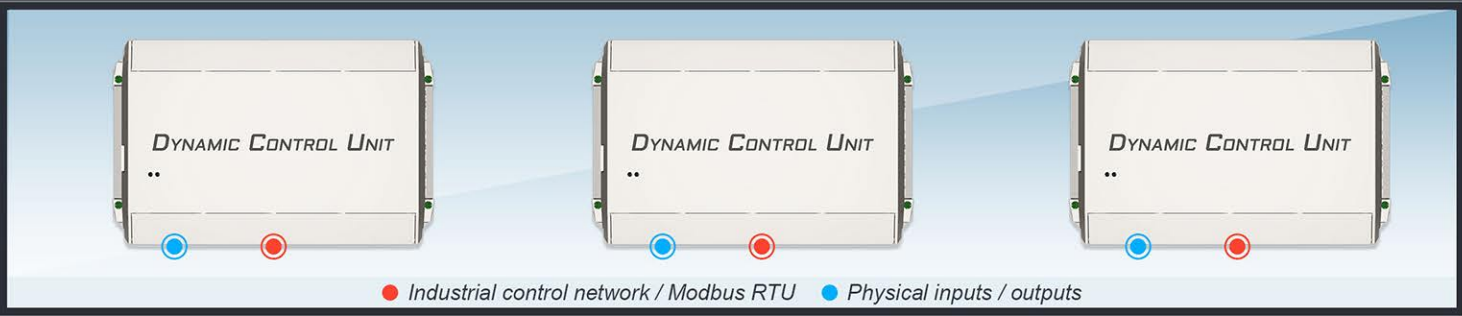

Hard real-time system / Sampling from 1ms / Precision 64-bit floating-point / Modbus RTU / Ethernet/TCP/UDP/IP / Analog inputs/outputs / 0-10V, 0-20mA, NTC/PT/Ni / Digital (binary) inputs/outputs / Contact/24VDC / Power supply 12-24VAC / 13-36 VDC

## DCU5610 (standard configuration)

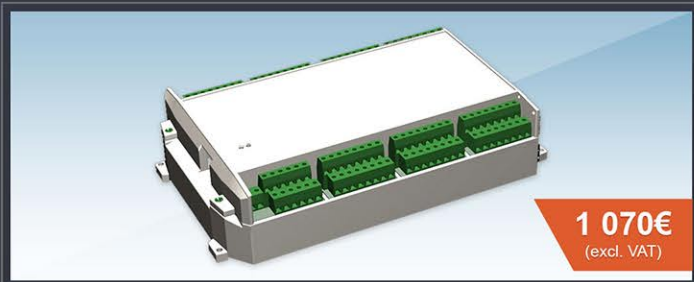

Sampling from 1ms  
64-bit floating point precision  
16 x analog inputs 0-10V, 0-20mA, NTC/PT/Ni, ...  
8 x analog outputs 0-10V, 0-20mA  
32 x digital inputs/outputs contact/24VDC/relay  
Modbus RTU  
TCP/UDP/IP Ethernet  
Power supply 12-24VAC / 13-36 VDC

## DCU2810

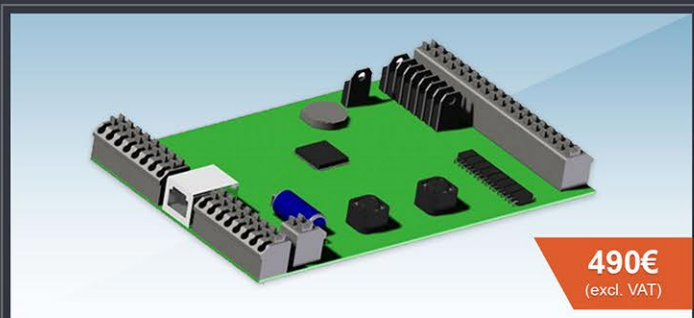

Sampling from 1ms  
64-bit floating point precision  
8 x analog inputs 0-10V, NTC/PT/Ni, ...  
4 x analog outputs 0-10V  
8 x digital inputs contact  
8 x digital outputs 24VDC  
Modbus RTU  
TCP/UDP/IP Ethernet  
Power supply 12-24VAC / 13-36 VDC

## MINI-PC SERVER



Mini-PC pre-installed as a control design and visualization server for monitoring more than 500 inputs/outputs.  
Linux Ubuntu  
Java/PHP/MySQL/Apache  
User Command Center  
Visualization/SCADA - standard web pages  
Scilab/Xcos  
from 2GB RAM  
from 64GB SSD

## TOUCH PANEL (TABLET)



Touch panel ready for process monitoring and visualization  
Screen size from 7" to 21"  
Android  
User Command Center  
Visualization/SCADA - standard web pages  
from 2GB RAM  
from 8GB SSD

## SERVICES

Guidance in design, implementation and optimization of control systems  
Control system design and programming  
Control system optimization  
Control system mounting and installation  
...

MORE INFO ON:

[www.prosystemy.sk](http://www.prosystemy.sk)

DCU  
**PROSYSTEMY**  
CONTROL SYSTEM

CONTACT:

PROSYSTEMY, s.r.o.  
J. Holčeka 339  
90086 Budmerice

Mobil: +421 905 479 804

email: [infoline@prosystemy.sk](mailto:infoline@prosystemy.sk)